



SIMAX[®]
BOROSILICATE GLASS 3.3

211 Shearson Crescent
Cambridge, ON, N1T1J5
Canada
T: 800.315.0387
F: 877.793.3335
sales@pegasus-glass.com
www.pegasus-glass.com

\$\$\$ INVENTORY BLOW OUT \$\$\$

STANDARD TUBING

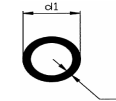

Code Number	d1 (mm)	d1 +/- (mm)	t (mm)	t +/- (mm)	ID (mm)	Approx. Case (pcs)	Approx. Case (lbs)	U.S. List per Case	Now 30% OFF
246 040 080	4	0.15	0.8	0.04	2.4	400	23.76	108.42	75.89
246 110 110	11	0.20	1.1	0.04	8.8	121	27.94	127.50	89.25
246 120 060	12	0.20	0.68	0.04	10.6	100	22.88	104.40	73.08
246 130 150	13	0.20	1.5	0.10	10.0	81	32.34	147.57	103.30
246 150 120	15	0.20	1.2	0.05	12.6	49	18.70	85.33	59.73
246 170 180	17	0.20	1.8	0.10	13.4	36	22.88	104.40	73.08
246 170 250	17	0.20	2.5	0.15	12.0	36	30.14	137.54	96.28
246 380 140	38	0.45	1.4	0.10	35.2	16	18.92	94.32	66.02
246 440 160	44	0.60	1.6	0.10	40.8	16	25.08	125.03	87.52
246 460 320	46	0.70	3.2	0.30	39.6	16	50.60	264.25	184.98
246 480 160	48	0.70	1.6	0.10	44.8	9	15.40	80.42	56.29
246 480 200	48	0.70	2.0	0.20	46.0	9	19.80	103.40	72.38
246 500 700	50	0.70	7.0	0.70	36.0	9	41.80	342.38	239.67
246 550 500	55	0.80	5.0	0.40	45.0	9	51.92	271.14	189.80
246 600 700	60	0.90	7.0	0.70	46.0	4	34.32	203.67	142.57
246 600 900	60	0.90	9.0	0.80	42.0	4	42.46	272.72	190.90
246 635 480	63.5	1.00	4.8	0.40	53.9	4	26.40	169.57	118.70
246 700 320	70	1.00	3.2	0.25	63.6	4	21.34	231.12	161.78
246 700 900	70	1.00	9.0	0.80	52.0	4	50.82	337.06	235.94
246 800 700	80	1.30	7.0	0.80	66.0	4	47.30	320.32	224.22
246 800 900	80	1.30	9.0	0.90	62.0	4	59.18	308.73	216.11
248 000 240	100	1.50	2.4	0.20	95.2	3	16.28	107.52	75.26

While supplies last
All sales are final with a no-return policy
Contact Pegasus for Quantity Discounts
Prices stated in US Dollars
Net 30 OAC / Visa / MasterCard
FOB: Cambridge, Ontario, Canada



211 Shearson Crescent
 Cambridge, ON, N1T1J5
 Canada
 T: 800.315.0387
 F: 877.793.3335
 sales@pegasus-glass.com
 www.pegasus-glass.com

\$\$\$ INVENTORY BLOW OUT \$\$\$

STANDARD TUBING

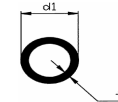

Code Number	d1 (mm)	d1 +/- (mm)	t (mm)	t +/- (mm)	ID (mm)	Approx. Case (pcs)	Approx. Case (lbs)	U.S. List per Case	Now 30% OFF
248 050 300	105	1.7	3.0	0.3	99.0	3	21.12	139.50	97.65
248 050 500	105	1.7	5.0	0.5	95.0	3	34.76	229.57	160.70
248 450 500	145	1.9	5.0	0.6	135.0	2	32.34	230.75	161.53
248 500 700	150	2.0	7.0	0.9	136.0	1	23.32	164.36	115.05
248 550 500	155	2.0	5.0	0.7	145.0	1	17.38	124.98	87.49
248 600 700	160	2.0	7.0	1.0	146.0	1	24.86	185.71	130.00
248 650 500	165	2.0	5.0	0.7	155.0	1	18.48	131.85	92.30
248 700 700	170	2.0	7.0	1.0	156.0	1	26.40	204.59	143.21
248 780 410	178	2.0	4.1	0.6	169.8	1	16.10	122.80	85.96
248 800 700	180	2.2	7.0	1.0	166.0	1	28.16	205.96	144.17

SCALLOP TUBING



Code Number	d (mm)	d +/- (mm)	t (mm)	t +/- (mm)	Approx. Case (pcs)	Approx. Case (lbs)	U.S. List per Case	Now 30% OFF
246 889 111	11	0.40	1.0	0.15	36	33.88	252.15	176.51
246 889 221	22	0.50	1.0	0.15	36	22.44	116.95	81.87
246 889 380	38	0.80	2.0	0.25	16	31.68	180.20	126.14
246 889 003	60	0.50	2.3	0.3	12	46.86	304.69	213.28
246 889 004	70	0.50	2.8	0.3	8	44.00	286.08	200.26
246 889 006	100	1.80	3.0	0.4	3	27.72	202.64	141.85

While supplies last
 All sales are final with a no-return policy
 Contact Pegasus for Quantity Discounts
 Prices stated in US Dollars
 Net 30 OAC / Visa / MasterCard
 FOB: Cambridge, Ontario, Canada



SIMAX[®]
BOROSILICATE GLASS 3.3

211 Shearson Crescent
Cambridge, ON, N1T1J5
Canada
T: 800.315.0387
F: 877.793.3335
sales@pegasus-glass.com
www.pegasus-glass.com

\$\$\$ INVENTORY BLOW OUT \$\$\$

IRIS TUBING



Code Number	x (mm)	x +/- (mm)	y (mm)	y +/- (mm)	Approx. Case (pcs)	Approx. Case (lbs)	U.S. List per Case	Now 30% OFF
246 888 050	15	1	7	0.5	74	50.38	276.44	193.51
246 888 051	19	1	9.5	1	36	44.44	243.84	170.69
246 888 056	24	1	10.5	1	25	48.18	264.37	185.06

DAISY TUBING



Code Number	x (mm)	x +/- (mm)	y (mm)	y +/- (mm)	Approx. Case (pcs)	Approx. Case (lbs)	U.S. List per Case	Now 30% OFF
246 888 101	9	0.5	4.0	0.5	168	46.20	253.31	177.32
246 888 102	10	0.5	4.5	0.5	100	42.46	221.89	155.32
246 888 104	12	0.5	5.3	0.5	90	48.40	265.57	185.90
246 888 109	17	0.5	7.0	0.5	36	36.52	200.38	140.27
246 888 110	18	0.5	7.8	0.5	36	37.84	207.63	145.34
246 888 112	20	0.5	8.2	0.5	36	49.72	272.82	190.97

While supplies last
All sales are final with a no-return policy
Contact Pegasus for Quantity Discounts
Prices stated in US Dollars
Net 30 OAC / Visa / MasterCard
FOB: Cambridge, Ontario, Canada



211 Shearson Crescent
 Cambridge, ON, N1T1J5
 Canada
 T: 800.315.0387
 F: 877.793.3335
 sales@pegasus-glass.com
 www.pegasus-glass.com

\$\$\$\$ INVENTORY BLOW OUT \$\$\$\$

CAPILLARY TUBING



Code Number	d1 (mm)	d1 +/- (mm)	d2 d ₂ (mm)	d2 +/- (mm)	Approx. Case (pcs)	Approx. Case (lbs)	U.S. List per Case	Now 30% OFF
261 071 526		0.25	1.5	0.1	122	33.00	184.48	129.14
261 072 026	7	0.25	2.0	0.1	122	31.68	177.10	123.97
261 072 526		0.25	2.5	0.1	122	30.14	168.50	117.95
261 081 026		0.25	1.0	0.08	100	36.52	204.16	142.91
261 083 026	8	0.25	3.0	0.1	100	31.68	177.10	123.97
261 083 526		0.25	3.5	0.1	100	29.92	167.26	117.08
261 093 526	9	0.25	3.5	0.1	81	32.34	180.79	126.55
261 101 526	10	0.25	1.5	0.1	64	36.08	201.70	141.19
261 103 526		0.25	3.5	0.1	64	32.56	182.02	127.41

TRIANGULAR CAPILLARY TUBING



Code Number	x (mm)	x +/- (mm)	d (mm)	Approx. Case (pcs)	Approx. Case (lbs)	U.S. List per Case	Now 30% OFF
261 710 301	11	0.50	1-1.5	75	32.8	187.95	131.57

While supplies last
 All sales are final with a no-return policy
 Contact Pegasus for Quantity Discounts
 Prices stated in US Dollars
 Net 30 OAC / Visa / MasterCard
 FOB: Cambridge, Ontario, Canada



211 Shearson Crescent
 Cambridge, ON, N1T1J5
 Canada
 T: 800.315.0387
 F: 877.793.3335
 sales@pegasus-glass.com
 www.pegasus-glass.com

\$\$\$ INVENTORY BLOW OUT \$\$\$

FLAT ROD



Code Number	x (mm)	x +/- (mm)	y (mm)	y +/- (mm)	Approx. Case (pcs)	Approx. Case (lbs)	U.S. List per Case	Now 30% OFF
271 063 228	6	0.50	3.2	0.50	280	32.12	128.14	89.70
271 084 228	8	0.50	4.2	0.50	160	33.44	133.41	93.39
271 115 828	11	0.50	5.8	0.50	91	35.20	145.49	101.84
271 125 428	12	0.50	5.4	0.50	84	33.66	139.11	97.38
271 136 928	13	0.50	6.9	0.50	66	35.64	147.31	103.12
271 177 528	17	0.50	7.5	0.50	40	32.12	137.60	96.32

HALF ROD



Code Number	d1 (mm)	d1 +/- (mm)	Approx. Case (pcs)	Approx. Case (lbs)	U.S. List per Case	Now 30% OFF
271 750 801	8	0.30	150	26.4	117.61	82.33
271 750 901	9	0.30	130	28.38	126.43	88.50
271 751 101	11	0.40	90	30.36	135.25	94.68
271 751 301	13	0.40	60	27.5	122.51	85.76
271 751 401	14	0.40	50	27.5	122.51	85.76
271 751 501	15	0.40	45	28.6	127.41	89.19

While supplies last
 All sales are final with a no-return policy
 Contact Pegasus for Quantity Discounts
 Prices stated in US Dollars
 Net 30 OAC / Visa / MasterCard
 FOB: Cambridge, Ontario, Canada



211 Shearson Crescent
 Cambridge, ON, N1T1J5
 Canada
 T: 800.315.0387
 F: 877.793.3335
 sales@pegasus-glass.com
 www.pegasus-glass.com

\$\$\$ INVENTORY BLOW OUT \$\$\$

RECTANGULAR ROD



Code Number	x (mm)	x +/- (mm)	y (mm)	y +/- (mm)	Approx. Case (pcs)	Approx. Case (lbs)	U.S. List per Case	Now 30% OFF
272 040 501	4	0.50	5.4	0.50	280	43.8	195.04	136.53
272 050 601	5	0.50	6.7	0.50	180	43.1	192.09	134.46
272 060 801	6	0.50	8.0	0.50	130	43.8	195.04	136.53
272 070 801	7	0.50	9.4	0.50	90	41.8	186.21	130.35
272 081 001	8	0.50	10.8	0.50	70	42.9	191.12	133.78
272 091 201	9	0.50	12.0	0.50	54	39.4	175.43	122.80
272 101 301	10	0.50	13.2	0.50	48	43.6	194.05	135.84

TRI ROD



Code Number	d1 (mm)	d1 +/- (mm)	Approx. Case (pcs)	Approx. Case (lbs)	U.S. List per Case	Now 30% OFF
271 710 306	6	0.40	180	24.86	110.75	77.53
271 710 304	8	0.40	100	24.42	108.79	76.15
271 710 303	9	0.40	80	24.86	110.75	77.53

While supplies last
 All sales are final with a no-return policy
 Contact Pegasus for Quantity Discounts
 Prices stated in US Dollars
 Net 30 OAC / Visa / MasterCard
 FOB: Cambridge, Ontario, Canada